

MEGA P MXT-2S

HI904T
HI904T21

INSTRUCTION MANUAL

1/8 Scale Nitro Power 4WD RTR Off Road Monster Truck



► Specifications

Lenght : 504mm
Width : 385mm
Height : 260mm
Wheelbase : 335mm
Tires Size : 114.5 x 71mm
Gear Ratio : 21:1(H)16.7:1(L)
Ground Clearance : 46mm
Engine : 18cxp (HI904T)
21cxp (HI904T21)

► Features

- 4WD Drive System
- 18CXP (3cc) / 21CXP (3.5cc) powerful engine with two valve needles and slide carb
- Waterproof dustproof sealed gearbox
- Auto-shifting 2-speed transmissions
- Sealed superduty plastic driveshaft
- Fast easy assembly and disassembly receiver and battery cover
- Quality differential with four level gear
- Blue anodised 6061T chassis
- Sealed gearbox waterproof and dustproof, durable and stable
- Adjustable threaded long Oil-filled shock absorber
- Fuel tank 125CC
- Precise sealed ball bearing for the whole model
- Aluminum exhaust pipe

Required equipment for operation

1.Tools required for buildin and mai ntenance:

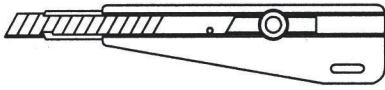

● Hobby knife

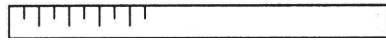

● Precision ruler

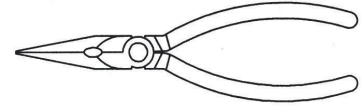

● Needle nose pliers

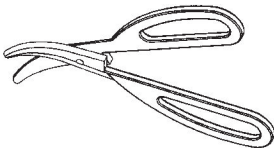

● Hobby scissors

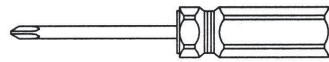
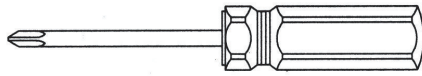

● Flat and Philips screwdriver

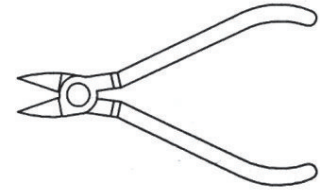

● Wire cutters

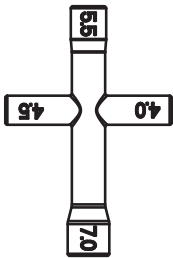

● Cross wrench

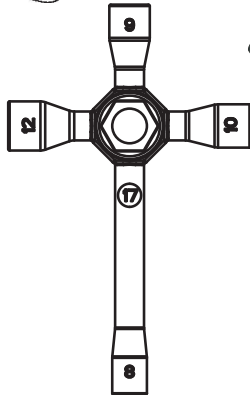

● Cross wrench



● CA glue & rubber cement

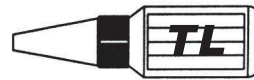

● Thread locking compound



1. 5mm



2. 0mm



2. 5mm

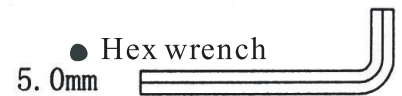

5. 0mm

● Hex wrench

Warning!

Do not use a power screw driver to install screws into nylon or plastic materials. The fast locking may heat up the screws being installed that may break the molded parts or strip the threads during installion.

IMPORTANT!!!

Check all the screw are tight before playing the car!
Use thread lock on all screws that work loose.

2.4GHZ RADIO SYSTEM

HTX-242



Install the batteries

- (1) Remove the battery compartment cover.
- (2) Replace the used batteries with new AA size batteries.

Please replace batteries when the power indicator blinks or the buzzer beeps.

Battery (Not Included)

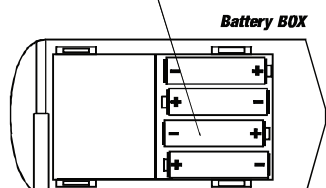

TRANSMITTER DIAGRAM

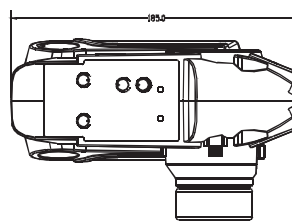
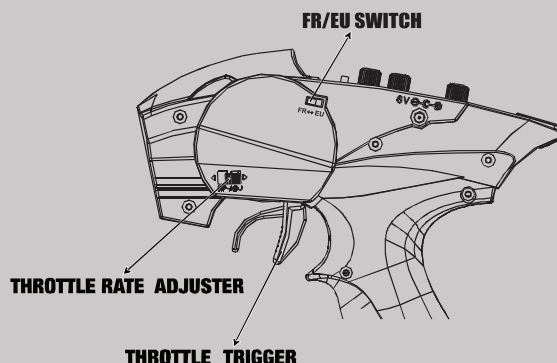

Transmitter Size

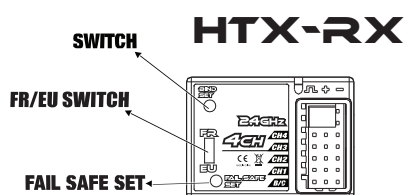

Connectors

- 1: Steering servo (CH1)
- 2: Throttle servo (CH2)
- 3: CH3 servo (CH3)
- 4: CH4 servo (CH4)
- B/C: Power connector

Receiver Size

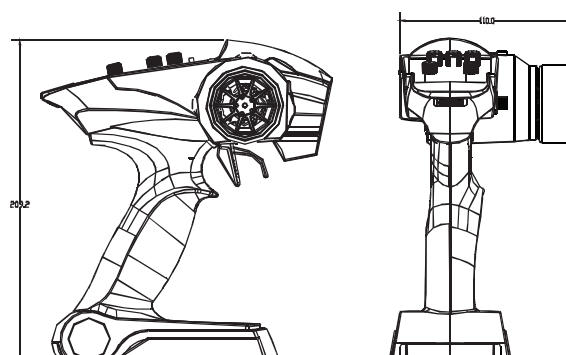
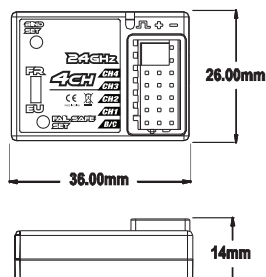

Transmitter Adjustment

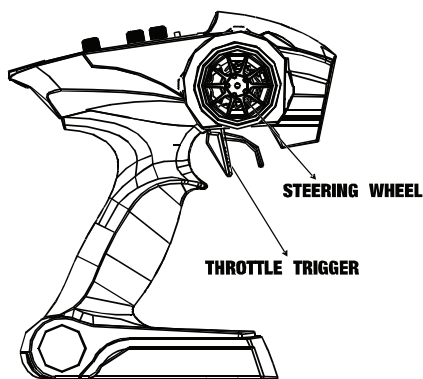

A. Throttle Trigger

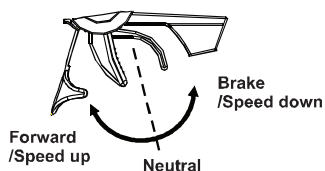

1. Push the trigger forward to slow down or brake.
2. Pull the trigger backward to accelerate.

Throttle Trim: Position the throttle trigger at the neutral position, adjust the throttle trim accordingly.

Steering Trim: If the front wheel does not align straight, use the steering trim to make adjustment.

B. Steering Wheel

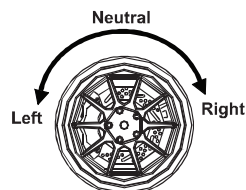

Turn the steering wheel counterclockwise to turn left, turn the steering wheel clockwise to turn right.



Position the transmitter and receiver 40cm apart when operating.

Low Battery Alarm

Do not operate the radio system when the battery power is low.

Fail Safe Function Setting

1. Set the TH, ST switches to the normal position.
2. Turn on the transmitter and receiver.
3. Press the F/S SET button, the LED on the receiver should start flashing rapidly.
4. Put the throttle trigger at the brake position, press the F/S SET button, the LED should become solid.
5. For electric model, put the throttle trigger at the stop position when you are making the setting.

2.4GHz

Binding the transmitter and receiver

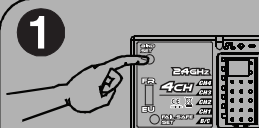

1. turn on the receiver power. Press the SW switch. The receiver's LED should start flashing.

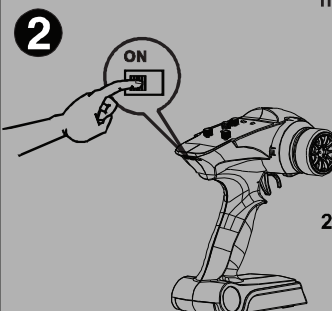

2. Turn on the transmitter.



3. When the LED on the receiver becomes solid, the binding process is completed.

Receiver and servo connection

Electrical powered model

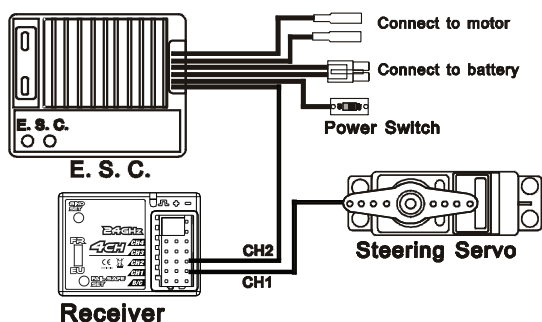

Gas powered model

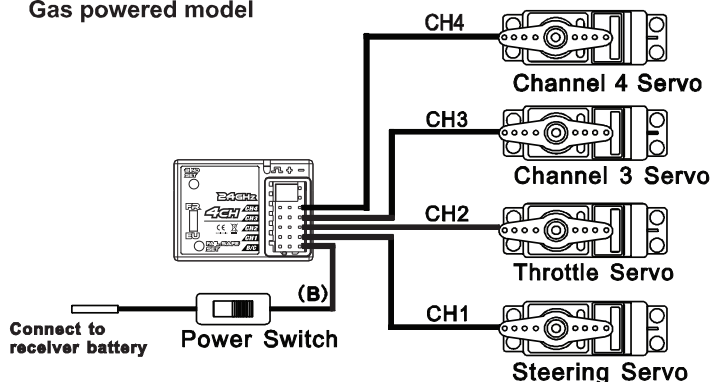

Operation Check List

1. Install fresh, new batteries into the transmitter and vehicle. Verify all the control functions are working properly.
2. Verify steering is set to the neutral position, the front wheels of the vehicle should point straight forward when the steering wheel on the transmitter is centered.
3. The ESC on the vehicle is pre-configured at the factory. When you turn on the transmitter and vehicle, you should hear a beep in 1-2 seconds and the indicator light should be lit.
4. With the battery fully charged, the run time for the vehicle is around 7 to 15 minutes depends on the condition of the running environment. Please stop operation when the battery show sign of low power.

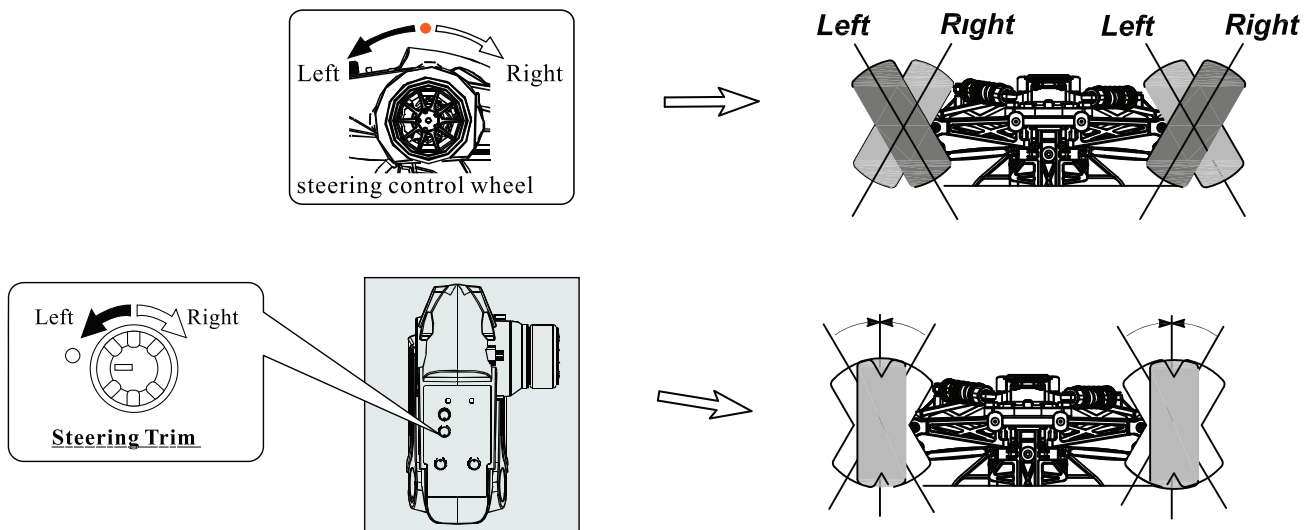

RC Operating Procedures

1. Load the battery on the transmitter.
2. Install the charged battery on the car.
3. Turn on the power switch before turning on the receiver.
4. Please raise the tires off the ground and check if the control is responding.
5. Hold the throttle trigger to let the car run. If it doesn't work, please adjust the throttle servo and trim.
6. Please replace the battery when the speed drops down.
7. When you finish the racing, please switch off the receiver first, and then the transmitter.
8. Please make sure the battery is disconnected and remove it after racing.

Engine Tuning Guide

High - Speed Needle

The “high-speed” needle is sticking up from the carburetor. This controls the fuel air mixture of the carburetor. The needle is pre-set for break-in from the factory at 2-1/2 turns out from fully closed,. Once the engine is broken-in, the high speed needle would typically run from 2 to 2-1/2 turns out from closed, depending on the weather, humidity and altitude above sea level.

To richen the mixture turn the needle counterclockwise, To learn it, turn the needle clockwise.

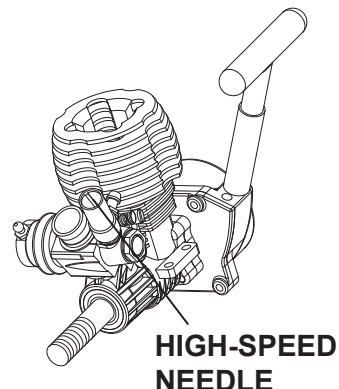

The Low- Speed Needle (For 18# engine)

The low-speed needle is the screw in the carb body opposite the throttle arm. It controls the fuel to air mixture at low throttle settings, There is a simple way of adjusting the low-speed needle correctly called the ‘pinch test’. With the engine at idle , pinch the fuel line and listen to how the engine speeds up or slow down. If the engine increases its speed for about 2 or 3 seconds and then loses speed, The needles is set correctly. If the engine loses RPM quickly, it is set too lean and the lowspeed needle needs to be opened (counterclockwise) to richen the mixture. Pinch again to check the mixture. If the engine takes longer than 4 seconds to slow down, lean (clockwise) the low-speed needle and then pinch again to check the mixture.

Idle Stop Screw

The ‘idle stop’ screw is located on the backside of the carburetor. This increases or decreases the idle speed without changing the fuel mixture. The barrel should be approximately 1mm from fully closed.

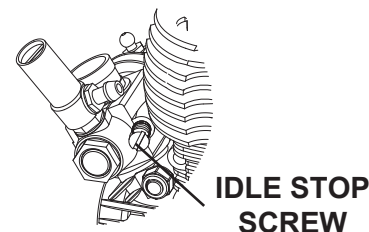

Important

To insure long life and good performance from your engine, you **MUST** break-in the engine. The break-in period is critical for long life of the internal parts of the engine. This should be done over the first 5 tanks of fuel.

Running The Engine

Starting the Engine

IMPORTANT! Your radio system must ALWAYS be turned on and the transmitter antenna fully extended when running the engine.

1. Fill th fuel tank.
2. Prepare to start the engine while it is cool, place your finger over the tuned pipe’s exhaust hole and pull the recoil gently several times. Do not over-prime! Stop when you see fuel in the fuel line at the crab.
3. Install a “C” alkaline into the glow starter and attach the starter to the glow plug.
4. With the throttle at idle, start the engine by pulling the recoil using short, quick pulls. Do NOT pull the recoil starter’s string to the end. You only need 10 to 12 inches of pull to start the engine with the throttle at idle.

Sometimes it is helpful to start the engine at around half throttle. When the engine Starts, immediately return the throttle to idle. If this is not done the engine can overheat and cause engine damage.

STOPPING THE ENGINE

Pinch the fuel line that runs to the carburetor. Pinching this line will restrict fuel flow and the engine will quit within a few seconds. Never place your finger over the exhaust to stop the engine. This could result in serious burns on your finger. It also causes fuel to back up in the engine, making it harder to start the next time you run your truck.

IMPORTANT! FIXING A FLOODED ENGINE

If the engine is difficult to turn over with the recoil starter, especially if it is brand new, loosen the glow plug a half turn before starting the engine. This allows some compression to escape, but the engine will still start. Make sure you tighten the glow plug after the engine has started. If the recoil starter is still difficult to pull, the engine is flooded—there is too much fuel inside the engine. Remove the glow plug, then turn the buggy upside down and pull the recoil 5 or 6 times. This will clear the engine of fuel, and you will notice the recoil pulls easier. Place the glow plug and repeat the starting procedure.

BREAK IN PROCEDURE

SOMETHINGS TO REMEMBER DURING BREAK-IN

1. Run with the body off. This will keep the engine cooler.
2. Keep the air cleaner on at ALL time.
3. Run on a smooth, hard surface. An empty parking lot is Perfect.
4. Use the same fuel that you will use for normal running.
5. Resist the urge to accelerate and decelerate quickly.
6. Break-in puts stress on the glow plug or two on hand.
7. DO NOT overheat the engine. You can check the head temperature by using one of the temperature gauges.

TANK 1

Your first tank of fuel should be running the truck at a very rich needle valve setting. This allows the fuel to carry as much oil as possible into the engine to properly lubricate the internal parts during the break-in.

1. Open the high speed needle valve 4-1/2 turns from fully closed (counterclockwise).
This is factory set already. But check it to make sure. When closing the high-speed needle, close until you feel some resistance. DO NOT Overtighten it will damage the engine.
2. Fill the fuel tank and start the engine.
3. Run the buggy on smooth surface with the body off.
4. Run back and forth at medium speeds accelerating and decelerating the car.
5. Run the buggy until the tank is almost out of the fuel. Do not allow the tank to run out of fuel during break-in. This leans out the engine and can cause overheating.
6. Stop the engine and allow it to cool. This normally takes around 10-15 minutes.

NOTE: if your engine does not stay running consistently, increase the idle speed by turning the idle stop screw clockwise.

TANK 2

Lean the high-speed needle 1/2 from 'tank 1' Run the car for the complete tank and then let it cool.

TANK 3

Lean the high-speed needle another 1/52 turn from 'tank 2' setting . Run the car for the complete tank and then let it cool.

TANK 4

Lean the high-speed needle another 1/2 turn from "tank3" setting. Run the car for the complete tank and then let it cool. You should notice the engine running much better at this point.

TANK 5

Lean the high-speed needle another 1/2 turn from "tank 4" setting. Run the car for the complete tank and then let it cool. The engine is now ready for tuning.

Important! At this point, the engine is likely to run at a faster idle than needed. (This is typical after break-in) Adjust the idle stop screw to lower the idle speed so that the wheels do not stop, or just barely rotate when you lift the car off the ground.

TUNING TIPS

After break-in, run the truck where you plan to do most of your driving (grass, street, track, etc). Tune the high speed needle so the engine makes good power without overheating. Using a temperature gauge to tune the engine so that it will consistently stay under 270F (132C). Keep in mind, RC engines usually take a minute or two to warm up. It is common not to reach full power right away. Never tune a cold engine.

ENGINE CARE

Never store your car with fuel in the tank. We recommend that after the final run of the day, empty the fuel tank and then run the engine at idle until all the fuel is out of the fuel lines and engine.

Remove air filter and glow plug, then place two drops of the After Run Engine Oil in the carburetor and two into the cylinder to help preventing corrosion . Pull the recoil a few times to circulate the oil.

10 WAYS TO ENSURE LONG LIFE FROM YOUR ENGINE

1. Keep your engine and air filter clean. Dirt will act insulation on an engine, it will not be able to shed heat as easily. Clean and re-oil the element often.
2. Do not over-lean your engine.
3. Do not run your engine with little or no load. Don't throttle up the engine to full throttle when the wheels are not in contact with the ground.
4. Do not overheat the engine.
5. Do not use a fuel with a low oil content. Make sure uses a model car fuel from a reputable manufacturer, such as O'Donnell Fuels.
6. Avoid using old fuels in the engine.
7. Do not use a fuel with a nitromethane (often called niteo) content over 20%.
8. Do not scratch the piston or cylinder sleeve. Avoid jamming something into the exhaust port when removing or re-installing the clutch or flywheel. Use a special tool called the Ultimate Flywheel Wrench to keep the crankshaft from moving.
9. Do not use silicone sealer on the engine joints. Silicone sealer contains acetic acid, which is corrosive if it get inside your engine.
10. Do not allow any water to get inside the engine. This sounds easy, but temperature changes can cause condensation inside the engine. This is good reason to use an after-running oil. Store your engine inside the house, not in a garage or shed where the temperature extremes.

ENGINE

SH18 SLIDE CARBURETOR TAIWAN ENGINE

Item No.:02060SH18B

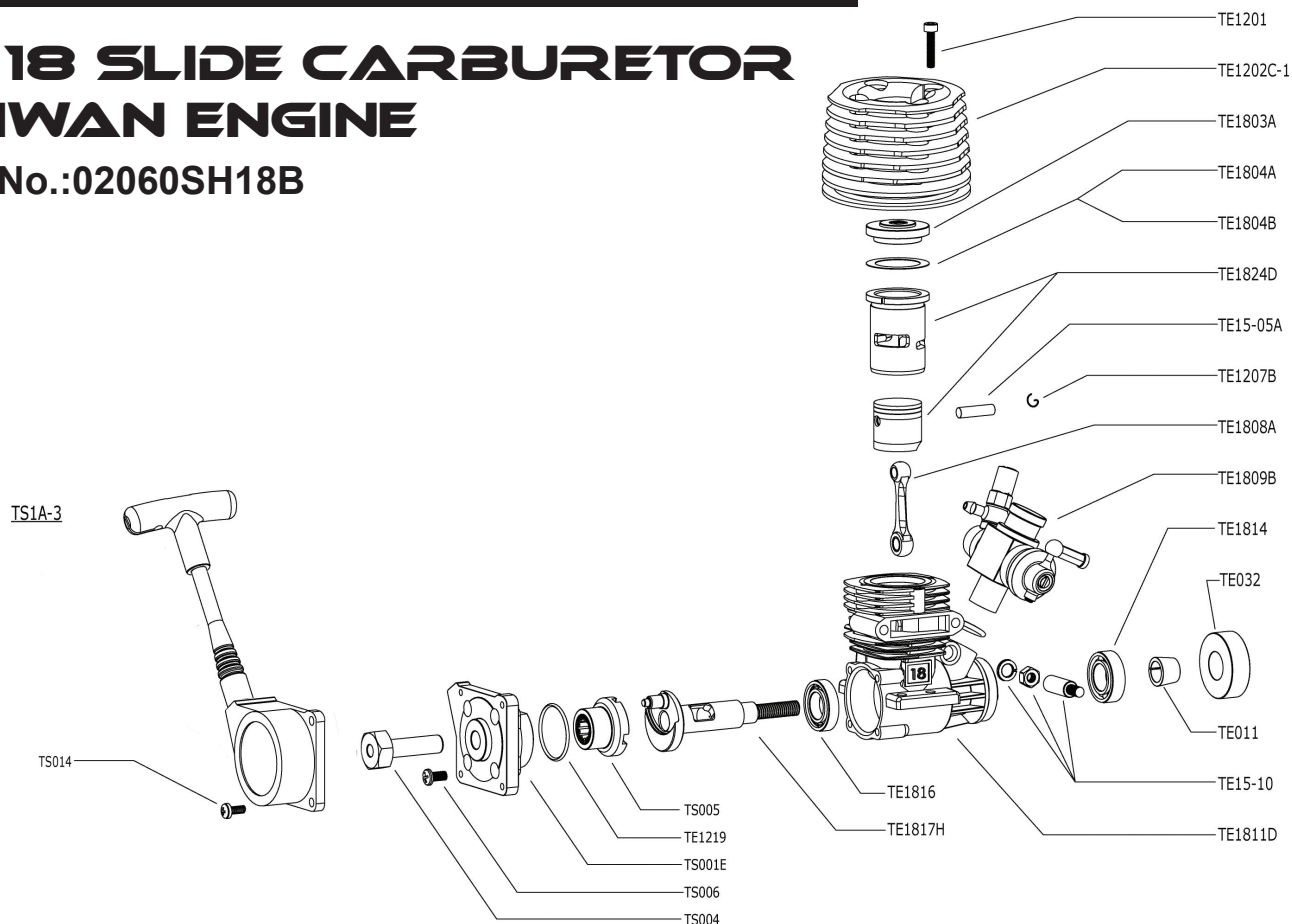

ENGINE

SH21 ENGINE

Item No.:SH21

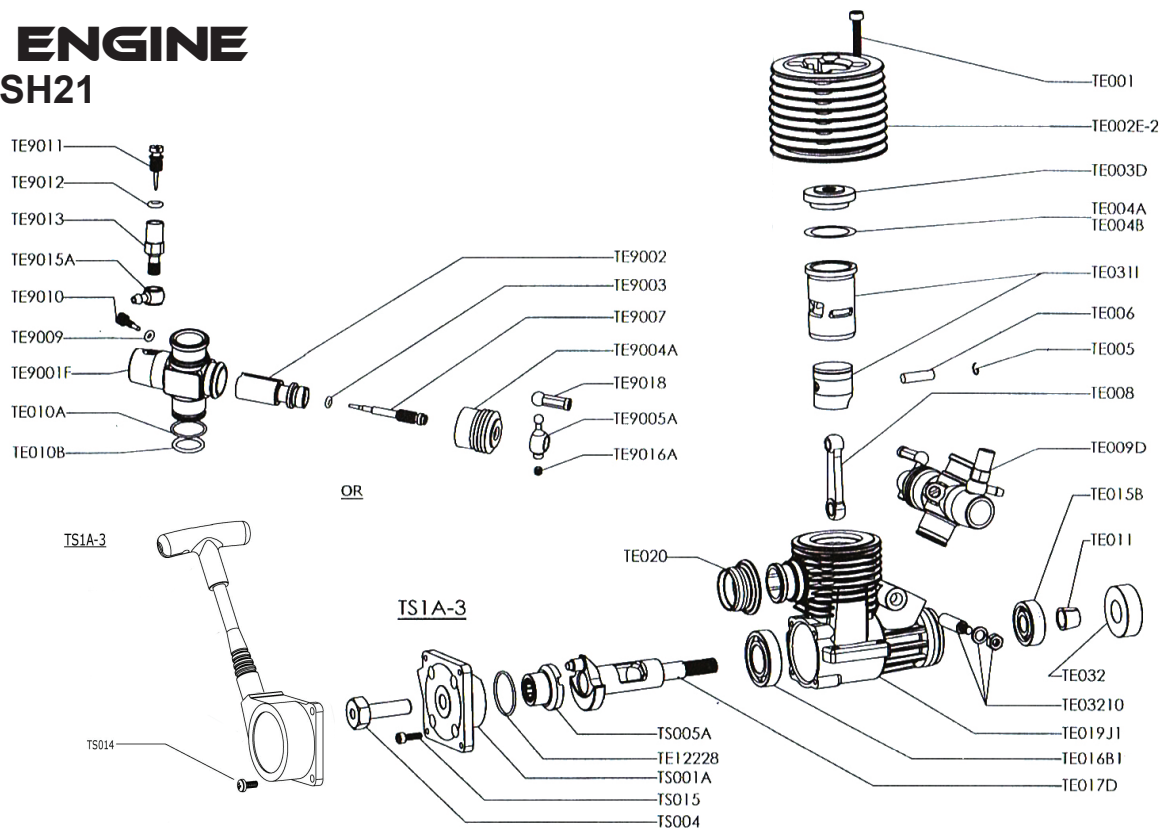

TECHNICAL DATA:

Type:	Cubic Capacity:	Bore:	Stroke:	R.P.M:	Power:	Weight:
PT1001B1	3.48 c.c.	16.40mm	16.40mm	28000	HP 2.1	400 g

09



H1904T21 EXPLODE DIAGRAM

This detailed explode diagram illustrates the assembly of the H1904T21 vehicle. The diagram shows the chassis, suspension, drivetrain, and wheels. Key components are labeled with part numbers, including:

- Chassis and Frame:** 904-003, 904-004, 904-005, 904-015, 904-017, 904-073, 904-074, 904-076, 904-077, 904-078, 904-079, 904-080, 904-081, 904-082, 904-083, 904-084, 904-085, 904-086, 904-087, 904-088, 904-089, 904-090, 904-091, 904-092, 904-093, 904-094, 904-095, 904-096, 904-097, 904-098, 904-099, 904-100, 904-101, 904-102, 904-103, 904-104, 904-105, 904-106, 904-107, 904-108, 904-109, 904-110, 904-111, 904-112, 904-113, 904-114, 904-115, 904-116, 904-117, 904-118, 904-119, 904-120, 904-121, 904-122, 904-123, 904-124, 904-125, 904-126, 904-127, 904-128, 904-129, 904-130, 904-131, 904-132, 904-133, 904-134, 904-135, 904-136, 904-137, 904-138, 904-139, 904-140, 904-141, 904-142, 904-143, 904-144, 904-145, 904-146, 904-147, 904-148, 904-149, 904-150, 904-151, 904-152, 904-153, 904-154, 904-155, 904-156, 904-157, 904-158, 904-159, 904-160, 904-161, 904-162, 904-163, 904-164, 904-165, 904-166, 904-167, 904-168, 904-169, 904-170, 904-171, 904-172, 904-173, 904-174, 904-175, 904-176, 904-177, 904-178, 904-179, 904-180, 904-181, 904-182, 904-183, 904-184, 904-185, 904-186, 904-187, 904-188, 904-189, 904-190, 904-191, 904-192, 904-193, 904-194, 904-195, 904-196, 904-197, 904-198, 904-199, 904-200, 904-201, 904-202, 904-203, 904-204, 904-205, 904-206, 904-207, 904-208, 904-209, 904-210, 904-211, 904-212, 904-213, 904-214, 904-215, 904-216, 904-217, 904-218, 904-219, 904-220, 904-221, 904-222, 904-223, 904-224, 904-225, 904-226, 904-227, 904-228, 904-229, 904-230, 904-231, 904-232, 904-233, 904-234, 904-235, 904-236, 904-237, 904-238, 904-239, 904-240, 904-241, 904-242, 904-243, 904-244, 904-245, 904-246, 904-247, 904-248, 904-249, 904-250, 904-251, 904-252, 904-253, 904-254, 904-255, 904-256, 904-257, 904-258, 904-259, 904-260, 904-261, 904-262, 904-263, 904-264, 904-265, 904-266, 904-267, 904-268, 904-269, 904-270, 904-271, 904-272, 904-273, 904-274, 904-275, 904-276, 904-277, 904-278, 904-279, 904-280, 904-281, 904-282, 904-283, 904-284, 904-285, 904-286, 904-287, 904-288, 904-289, 904-290, 904-291, 904-292, 904-293, 904-294, 904-295, 904-296, 904-297, 904-298, 904-299, 904-300, 904-301, 904-302, 904-303, 904-304, 904-305, 904-306, 904-307, 904-308, 904-309, 904-310, 904-311, 904-312, 904-313, 904-314, 904-315, 904-316, 904-317, 904-318, 904-319, 904-320, 904-321, 904-322, 904-323, 904-324, 904-325, 904-326, 904-327, 904-328, 904-329, 904-330, 904-331, 904-332, 904-333, 904-334, 904-335, 904-336, 904-337, 904-338, 904-339, 904-340, 904-341, 904-342, 904-343, 904-344, 904-345, 904-346, 904-347, 904-348, 904-349, 904-350, 904-351, 904-352, 904-353, 904-354, 904-355, 904-356, 904-357, 904-358, 904-359, 904-360, 904-361, 904-362, 904-363, 904-364, 904-365, 904-366, 904-367, 904-368, 904-369, 904-370, 904-371, 904-372, 904-373, 904-374, 904-375, 904-376, 904-377, 904-378, 904-379, 904-380, 904-381, 904-382, 904-383, 904-384, 904-385, 904-386, 904-387, 904-388, 904-389, 904-390, 904-391, 904-392, 904-393, 904-394, 904-395, 904-396, 904-397, 904-398, 904-399, 904-400, 904-401, 904-402, 904-403, 904-404, 904-405, 904-406, 904-407, 904-408, 904-409, 904-410, 904-411, 904-412, 904-413, 904-414, 904-415, 904-416, 904-417, 904-418, 904-419, 904-420, 904-421, 904-422, 904-423, 904-424, 904-425, 904-426, 904-427, 904-428, 904-429, 904-430, 904-431, 904-432, 904-433, 904-434, 904-435, 904-436, 904-437, 904-438, 904-439, 904-440, 904-441, 904-442, 904-443, 904-444, 904-445, 904-446, 904-447, 904-448, 904-449, 904-450, 904-451, 904-452, 904-453, 904-454, 904-455, 904-456, 904-457, 904-458, 904-459, 904-460, 904-461, 904-462, 904-463, 904-464, 904-465, 904-466, 904-467, 904-468, 904-469, 904-470, 904-471, 904-472, 904-473, 904-474, 904-475, 904-476, 904-477, 904-478, 904-479, 904-480, 904-481, 904-482, 904-483, 904-484, 904-485, 904-486, 904-487, 904-488, 904-489, 904-490, 904-491, 904-492, 904-493, 904-494, 904-495, 904-496, 904-497, 904-498, 904-499, 904-500, 904-501, 904-502, 904-503, 904-504, 904-505, 904-506, 904-507, 904-508, 904-509, 904-510, 904-511, 904-512

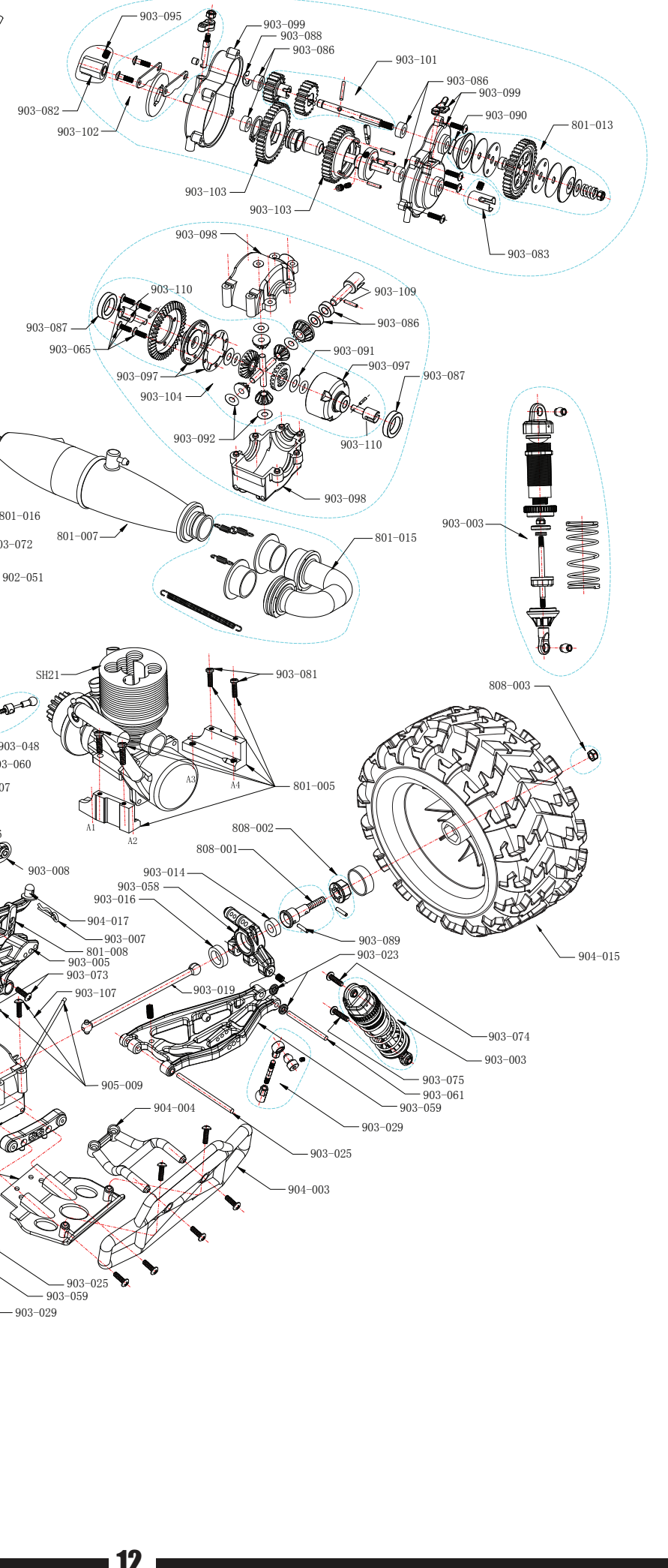

COMMON PARTS

801-009



Aluminum Exhaust
Fixation Set

801-012



(904-011) Gearbox Unit

801-013



(904-012) Spur Gear/
Spring/Nylon Locknut

801-014



Spurgear 43T

801-016



125CC Fuel Tank

808-001



M5 Rim Hub W/Pin

808-002



M5 Axle W/Pin

808-003



M5 Nylon Locknut 6P

902-051



Screw BT3*10 12P

903-003



Shock Absorber Unit
(Plastic)

903-005



Brace

903-007



Body Clip 6P

903-008



Upper Susp. Arm Set

903-010



Susp. Arm Mount Block

903-011



Upper Susp. Arm
Mount-Fr/Rr

903-014



Ball Bearing 6*12*4 2P

903-016



Ball Bearing 10*15*4 2P

903-017T



Fr/Rr C-Carrier W/M4
Screw

903-018



Fr.Lower Susp.Arm (L/R)
2P

903-019



Transverse Driver Shaft
Set 80.4MM

903-023



O-Washer 8P

903-024



Front Suspension Arm
Pin (Short)

903-025



Suspension Arm Pin (Long)

903-026



Fr. Chassis

903-028



Lower Susp. Mount
Block-Fr/Rr

COMMON PARTS

903-029



Anti-Roll Bar Fixation Set

903-030



Steering Linkage Set

903-031



Servo Saver Unit

903-032



Upper Deck-Fr

903-033



Battery Case

903-034



Switch/Switch Cover/
Screw

903-035



Battery Case Cover/
Receiver

903-036



Handle W/Fuel Pipe Hoop

903-037



Steering Servo Horn And
Linkage

903-038



Steering Servo Mount-A/B

903-039



Upper Deck-Center

903-040



Upper Deck Mount

903-043



Side Guard Plate (L/R)

903-044



Throttle Servo Mount-A/B

903-045



Throttle Servo Horn And
Linkage Set

903-048



Throttle Linkage Set

903-052



Clutch Shoe W/Spring

903-058



Rear Hub

903-059



Rr.Lower Susp.Arm (L/R)

903-060



Fuel Pipe

903-061



Rear Suspension Arm
Pin-Short

903-065



Flat Cross Screw
(TPF2.6*10) 12P

903-066



Flat Cross Screw (TPF3*8)
12P

903-067



Flat Cross Screw
(TPF3*10) 12P

903-068



Flat Cross Screw
(TPF3*14) 12P

COMMON PARTS

903-069



Flat Cross Screw
(TPF3*16) 12P

903-070



Flat Cross Screw
(ISO3*10) 12P

903-071



B-Head Cross Screw
(BT2.6*6) 12P

903-072



B-Head Cross Screw
(BT3*8) 12P

903-073



B-Head Cross Screw
(BT3*12) 12P

903-074



B-Head Cross Screw
(BT3*14) 12P

903-075



B-Head Cross Screw
(BT3*16) 12P

903-076



B-Head Cross Screw
(BT3*20) 12P

903-079



B-Head Cross Screw
(BM3*10) 12P

903-081



Cap Head Hexagon
Screw (HM3*10) 6P

903-082



Diff. Outdrive A

903-083



Diff. Outdrive B

903-086



Ball Bearing 5*10*4 2P

903-087



Ball Bearing 12*18*4 2P

903-088



E-Clip 4*0.6 12P

903-089



Pin 2*9.5 12P

903-090



Pin 2*12.5 12P

903-091



Washer A (5.2*10*0.2)
12P

903-092



Washer B (4.2*8*0.2) 12P

903-094



Double Way Ball End
(7*8) 6P

903-095



Set Screw M4*4 12P

903-096



Set Screw M4*8 6P

903-097



Diff. Gearbox

903-098



Diff. Gearbox Bulkhead
-Upper/Lower

903-099



Gearbox Bulkhead-Fr./Rr.

COMMON PARTS

903-101



Pinion Gear-18T/19T/Pin

903-102



Brake Set

903-103



Gear-40T/37T

903-105



Driving/Driven Gear,
Diff. Gear/Bevel Gears

903-106



Screw Pin M3*9.5 12P

903-107



Antenna Mount 3P

903-109



Outdrive Cups (Longer)

903-110



Outdrive Cups (Shorter)

904-003



Bumper 2P

904-004



Bumper Brace 2P

904-005



Bumper Chassis-Fr

904-006



Bumper Chassis-Rr

904-007



Upper Plate-Rr

904-009



Dogbone-Fr

904-010



Dogbone-Rr

904-017



Fr/Rr Body Mount

905-009



Rear Anti-Roll Bar Set

933-011



Clutch Bell

904-015



Fr/Rr Patterned Tire Unit
Chromed 2P

PARTS H1904T ONLY

901-066



Nylon Nut M3 5P

902-031



Air Filter W/Insert

903-049

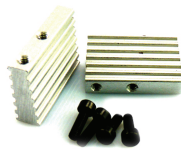

Engine Mount

903-050



Engine Flywheel W/Pin

903-051



Engine Crankshaft
W/E-Clip

903-054



Exhaust Manifold

903-055



Exhaust Pipe Coupler

903-080



Cap Head Hexagon
Screw (HM3*25)

903-112



Motor Washer 4P Screw,
4P Washer

904-008



Chassis

02060SH18B



SH18 Engine

MP0-12

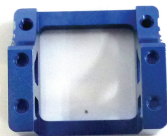

Engine Mount 1P

MP0-15



Aluminum Exhaust Pipe

PARTS H1904T21 ONLY

801-001



Chassis

801-003



Engine Washer/Screw

801-004



Engine Crankshaft W/E-Clip

801-005

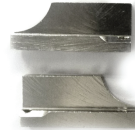

Engine Mount (L/F)

801-006



Engine Flywheel W/Pin

801-007



Aluminum Exhaust Pipe

801-011



IS 04*10 Flat Cross
Screw/Washer

801-015



Exhaust Manifold

801-019



Air Filter W/Insert

SH21



SH21 Engine

ELECTRONICS PARTS

HTX-242



Two Button 2.4 Ghz
Radio Set

HTX-242T



Two Button 2.4 Ghz Radio

HTX-RX



4channels 2.4G
Receiver 1P

SERV06KG



6Kg Throttle Servo

SERV09KG



9Kg Steering Servo

02057S



Antenna Pipe W/Cap 3P

B7026-008



Back Plate 1P

TS1A-3



SH18,SH21 Pullstart

02372



Steering Servo Arm 2P

UPGRADE PARTS

MP0-02



C Hub, C Hub Pin,
Stainless Steel

MP0-03



(903-111)
Knuckle Arm Set

MP0-04



Rear Hub Set Stainless
Steel

MP0-05



Shock Stay Mount

MP0-06



Front Suspension Mount

MP0-07



Rear Front Suspension

MP0-08



Steel Brake Disk
Stainless Steel

MP0-09



Special Brake Pads
Stainless Steel

MP0-10



Brake Post

MP0-11



Steering Rod Stainless
Steel

MP0-13



Slipper System Hard
Anodize

MP0-14

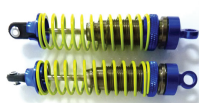

(903-004) Aluminum
Shock 2P

MP0-17



43T Metal Gear

Spare Parts List

HI904T

801-009	Aluminum Exhaust Fixation Set	SP
801-012	(904-011) Gearbox Unit	SP
801-013	(904-012) Spur Gear/Spring/Nylon Locknut	SP
801-014	Spurgear 43T	SP
801-016	125CC Fuel Tank	SP
808-001	M5 Rim Hub W/Pin	SP
808-002	M5 Axle W/Pin	SP
808-003	M5 Nylon Locknut 6P	SP
902-051	Screw BT3*10 12P	SP
903-003	Shock Absorber Unit (Plastic)	SP
903-005	Brace	SP
903-007	Body Clip 6P	SP
903-008	Upper Susp. Arm Set	SP
903-010	Suspension Arm Mount Block	SP
903-011	Upper Susp. Arm Mount-Fr/Rr	SP
903-014	Ball Bearing 6*12*4 2P	SP
903-016	Ball Bearing 10*15*4 2P	SP
903-017T	Fr/Rr C-Carrier W/M4 Screw	SP
903-018	Fr.Lower Susp.Arm (L/R) 2P	SP
903-019	Transverse Driver Shaft Set 80.4MM	SP
903-023	O-Washer 8P	SP
903-024	Front Suspension Arm Pin (Short)	SP
903-025	Suspension Arm Pin (Long)	SP
903-026	Fr. Chassis	SP
903-028	Lower Susp. Mount Block-Fr/Rr	SP
903-029	Anti-Roll Bar Fixation Set	SP
903-030	Steering Linkage Set	SP
903-031	Servo Saver Unit	SP
903-032	Upper Deck-Fr	SP
903-033	Battery Case	SP
903-034	Switch/Switch Cover/Screw	SP
903-035	Receiver/Battery Case Cover	SP
903-036	Handle W/Fuel Pipe Hoop	SP
903-037	Steering Servo Horn And Linkage	SP
903-038	Steering Servo Mount-A/B	SP
903-039	Upper Deck-Center	SP
903-040	Upper Deck Mount	SP
903-043	Side Guard Plate (L/R)	SP
903-044	Throttle Servo Mount-A/B	SP
903-045	Throttle Servo Horn And Linkage Set	SP
903-048	Throttle Linkage Set	SP
903-052	Clutch Shoe W/Spring	SP
903-058	Rear Hub	SP
903-059	Rr.Lower Susp.Arm (L/R)	SP
903-060	Fuel Pipe	SP
903-061	Rear Suspension Arm Pin-Short	SP
903-065	Flat Cross Screw (TPF2.6*10) 12P	SP
903-066	Flat Cross Screw (TPF3*8) 12P	SP
903-067	Flat Cross Screw (TPF3*10) 12P	SP
903-068	Flat Cross Screw (TPF3*14) 12P	SP
903-069	Flat Cross Screw (TPF3*16) 12P	SP
903-070	Flat Cross Screw (ISO3*10) 12P	SP
903-071	B-Head Cross Screw (BT2.6*6) 12P	SP
903-072	B-Head Cross Screw (BT3*8) 12P	SP
903-073	B-Head Cross Screw (BT3*12) 12P	SP
903-074	B-Head Cross Screw (BT3*14) 12P	SP
903-075	B-Head Cross Screw (BT3*16) 12P	SP
903-076	B-Head Cross Screw (BT3*20) 12P	SP
903-079	B-Head Cross Screw (BM3*10) 12P	SP
903-081	Cap Head Hexagon Screw (HM3*10) 6P	SP
903-082	Diff. Outdrive A	SP
903-083	Diff. Outdrive B	SP
903-086	Ball Bearing 5*10*4 2P	SP
903-087	Ball Bearing 12*18*4 2P	SP

903-088	E-Clip 4*0.6 12P	SP
903-089	Pin 2*9.5 12P	SP
903-090	Pin 2*12.5 12P	SP
903-091	Washer A (5.2*10*0.2) 12P	SP
903-092	Washer B (4.2*8*0.2) 12P	SP
903-094	Double Way Ball End (7*8) 6P	SP
903-095	Set Screw M4*4 12P	SP
903-096	Set Screw M4*8 6P	SP
903-097	Diff. Gearbox	SP
903-098	Diff. Gearbox Bulkhead-Upper/Lower	SP
903-099	Gearbox Bulkhead-Fr./Rr.	SP
903-101	Pinion Gear-18T/19T/Pin	SP
903-102	Brake Set	SP
903-103	Gear-40T/37T	SP
903-105	Driving/Driven Gear, Diff.Gear/Bevel Gears	SP
903-106	Screw Pin M3*9.5 12P	SP
903-107	Antenna Mount 3P	SP
903-109	Outdrive Cups (Longer)	SP
903-110	Outdrive Cups (Shorter)	SP
904-003	Bumper 2P	SP
904-004	Bumper Brace 2P	SP
904-005	Bumper Chassis-Fr	SP
904-006	Bumper Chassis-Rr	SP
904-007	Upper Plate-Rr	SP
904-009	Dogbone-Fr	SP
904-010	Dogbone-Rr	SP
904-017	Fr/Rr Body Mount	SP
905-009	Rear Anti-Roll Bar Set	SP
933-011	Clutch Bell	SP
904-015	Fr/Rr Patterned Tire Unit Chromed 2P	TR
901-066	Nylon Nut M3 5P	SP
902-031	Air Filter W/Insert	SP
903-049	Engine Mount	SP
903-050	Engine Flywheel W/Pin	SP
903-051	Engine Crankshaft W/E-Clip	SP
903-054	Exhaust Manifold	SP
903-055	Exhaust Pipe Coupler	SP
903-080	Cap Head Hexagon Screw (HM3*25)	SP
903-112	Motor Washer 4P Screw, 4P Washer	SP
904-008	Chassis	SP
020575	Antenna Pipe W/Cap 4P	EP
02060SH18B	SH18 Slide Carburetor Taiwan Engine	EP
B7026-008	Back Plate (Suitable for MegaP) 1P	EP
HTX-242	Two Button 2.4 Ghz Radio Set	EP
HTX-242T	Two Button 2.4 Ghz Radio	EP
HTX-RX	4channels 2.4G Receiver 1P	EP
SERVO6KG	6Kg Servo	EP
SERVO9KG	9Kg Servo	EP
TS1A-3	SH18,SH21 Pullstart	EP
02372	Steering Servo Arm 2P	EP
MPO-02	C Hub, C Hub Pin, Stainless Steel	UP
MPO-03	Knuckle Arm Set	UP
MPO-04	Rear Hub Set Stainless Steel	UP
MPO-05	Shock Stay Mount	UP
MPO-06	Front Suspension Mount	UP
MPO-07	Rear Front Suspension	UP
MPO-08	Steel Brake Disk Stainless Steel	UP
MPO-09	Special Brake Pads Stainless Steel	UP
MPO-10	Brake Post	UP
MPO-11	Steering Rod Stainless Steel	UP
MPO-12	Engine Mount 1P	UP
MPO-13	Slipper System Hard Anodize	UP
MPO-14	(903-004) Aluminum Shock 2P	UP
MPO-15	(02124) Aluminum Exhaust Pipe	UP
MPO-17	43T Metal Gear	UP

Spare Parts List

HI904T21

801-009	Aluminum Exhaust Fixation Set	SP
801-012	(904-011) Gearbox Unit	SP
801-013	(904-012) Spur Gear/Spring/Nylon Locknut	SP
801-014	Spurgear 43T	SP
801-016	125CC Fuel Tank	SP
808-001	M5 Rim Hub W/Pin	SP
808-002	M5 Axle W/Pin	SP
808-003	M5 Nylon Locknut 6P	SP
902-051	Screw BT3*10 12P	SP
903-003	Shock Absorber Unit (Plastic)	SP
903-005	Brace	SP
903-007	Body Clip 6P	SP
903-008	Upper Susp. Arm Set	SP
903-010	Suspension Arm Mount Block	SP
903-011	Upper Susp. Arm Mount-Fr/Rr	SP
903-014	Ball Bearing 6*12*4 2P	SP
903-016	Ball Bearing 10*15*4 2P	SP
903-017T	Fr/Rr C-Carrier W/M4 Screw	SP
903-018	Fr.Lower Susp.Arm (L/R) 2P	SP
903-019	Transverse Driver Shaft Set 80.4MM	SP
903-023	O-Washer 8P	SP
903-024	Front Suspension Arm Pin (Short)	SP
903-025	Suspension Arm Pin (Long)	SP
903-026	Fr. Chassis	SP
903-028	Lower Susp. Mount Block-Fr/Rr	SP
903-029	Anti-Roll Bar Fixation Set	SP
903-030	Steering Linkage Set	SP
903-031	Servo Saver Unit	SP
903-032	Upper Deck-Fr	SP
903-033	Battery Case	SP
903-034	Switch/Switch Cover/Screw	SP
903-035	Receiver/Battery Case Cover	SP
903-036	Handle W/Fuel Pipe Hoop	SP
903-037	Steering Servo Horn And Linkage	SP
903-038	Steering Servo Mount-A/B	SP
903-039	Upper Deck-Center	SP
903-040	Upper Deck Mount	SP
903-043	Side Guard Plate (L/R)	SP
903-044	Throttle Servo Mount-A/B	SP
903-045	Throttle Servo Horn And Linkage Set	SP
903-048	Throttle Linkage Set	SP
903-052	Clutch Shoe W/Spring	SP
903-058	Rear Hub	SP
903-059	Rr.Lower Susp.Arm (L/R)	SP
903-060	Fuel Pipe	SP
903-061	Rear Suspension Arm Pin-Short	SP
903-065	Flat Cross Screw (TPF2.6*10) 12P	SP
903-066	Flat Cross Screw (TPF3*8) 12P	SP
903-067	Flat Cross Screw (TPF3*10) 12P	SP
903-068	Flat Cross Screw (TPF3*14) 12P	SP
903-069	Flat Cross Screw (TPF3*16) 12P	SP
903-070	Flat Cross Screw (ISO3*10) 12P	SP
903-071	B-Head Cross Screw (BT2.6*6) 12P	SP
903-072	B-Head Cross Screw (BT3*8) 12P	SP
903-073	B-Head Cross Screw (BT3*12) 12P	SP
903-074	B-Head Cross Screw (BT3*14) 12P	SP
903-075	B-Head Cross Screw (BT3*16) 12P	SP
903-076	B-Head Cross Screw (BT3*20) 12P	SP
903-079	B-Head Cross Screw (BM3*10) 12P	SP
903-081	Cap Head Hexagon Screw (HM3*10) 6P	SP
903-082	Diff. Outdrive A	SP
903-083	Diff. Outdrive B	SP

903-086	Ball Bearing 5*10*4 2P	SP
903-087	Ball Bearing 12*18*4 2P	SP
903-088	E-Clip 4*0.6 12P	SP
903-089	Pin 2*9.5 12P	SP
903-090	Pin 2*12.5 12P	SP
903-091	Washer A (5.2*10*0.2) 12P	SP
903-092	Washer B (4.2*8*0.2) 12P	SP
903-094	Double Way Ball End (7*8) 6P	SP
903-095	Set Screw M4*4 12P	SP
903-096	Set Screw M4*8 6P	SP
903-097	Diff. Gearbox	SP
903-098	Diff. Gearbox Bulkhead-Upper/Lower	SP
903-099	Gearbox Bulkhead-Fr./Rr.	SP
903-101	Pinion Gear-18T/19T/Pin	SP
903-102	Brake Set	SP
903-103	Gear-40T/37T	SP
903-105	Driving/Driven Gear, Diff.Gear/Bevel Gears	SP
903-106	Screw Pin M3*9.5 12P	SP
903-107	Antenna Mount 3P	SP
903-109	Outdrive Cups (Longer)	SP
903-110	Outdrive Cups (Shorter)	SP
904-003	Bumper 2P	SP
904-004	Bumper Brace 2P	SP
904-005	Bumper Chassis-Fr	SP
904-006	Bumper Chassis-Rr	SP
904-007	Upper Plate-Rr	SP
904-009	Dogbone-Fr	SP
904-010	Dogbone-Rr	SP
904-017	Fr/Rr Body Mount	SP
905-009	Rear Anti-Roll Bar Set	SP
933-011	Clutch Bell	SP
904-015	Fr/Rr Patterned Tire Unit Chromed 2P	TR
801-001	Chassis	SP
801-003	Engine Washer/Screw	SP
801-004	Engine Crankshaft W/E-Clip	SP
801-005	Engine Mount (L/F)	SP
801-006	Engine Flywheel W/Pin	SP
801-007	Aluminum Exhaust Pipe	SP
801-011	IS 04*10 Flat Cross Screw/Washer	SP
801-015	Exhaust Manifold	SP
801-019	Air Filter W/Insert	SP
02057S	Antenna Pipe W/Cap 4P	EP
HTX-242	Two Button 2.4 Ghz Radio Set	EP
HTX-242T	Two Button 2.4 Ghz Radio	EP
HTX-RX	4channels 2.4G Receiver 1P	EP
SERVO6KG	6Kg Servo	EP
SERVO9KG	9Kg Servo	EP
SH21	SH21 Engine	EP
TS1A-3	SH18,SH21 Pullstart	EP
02372	Steering Servo Arm 2P	EP
MPO-02	C Hub, C Hub Pin, Stainless Steel	UP
MPO-03	Knuckle Arm Set	UP
MPO-04	Rear Hub Set Stainless Steel	UP
MPO-05	Shock Stay Mount	UP
MPO-06	Front Suspension Mount	UP
MPO-07	Rear Front Suspension	UP
MPO-08	Steel Brake Disk Stainless Steel	UP
MPO-09	Special Brake Pads Stainless Steel	UP
MPO-10	Brake Post	UP
MPO-11	Steering Rod Stainless Steel	UP
MPO-13	Slipper System Hard Anodize	UP
MPO-14	(903-004) Aluminum Shock 2P	UP
MPO-17	43T Metal Gear	UP

HIMOTO